

Hardware/Quincaillerie



A
42x



B
36x



C
42x



D
36x



E
48x



F
42x

To prevent parts damage, ensure that nuts, nut bolts, screws or cam lock are not over-tightened.
Afin de prévenir le dommage des pièces, assurez-vous que les boulons, les écrous, les vis ou les verrous à came ne soient pas trop serrés

Tools Required/Outils requis

Power tools NOT recommended/Utilisation d'outils électriques NON recommandée

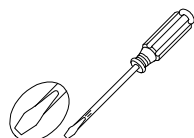

(not included/pas inclus)

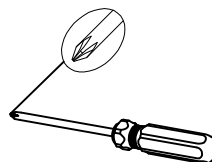

(not included/pas inclus)

Components/Composantes

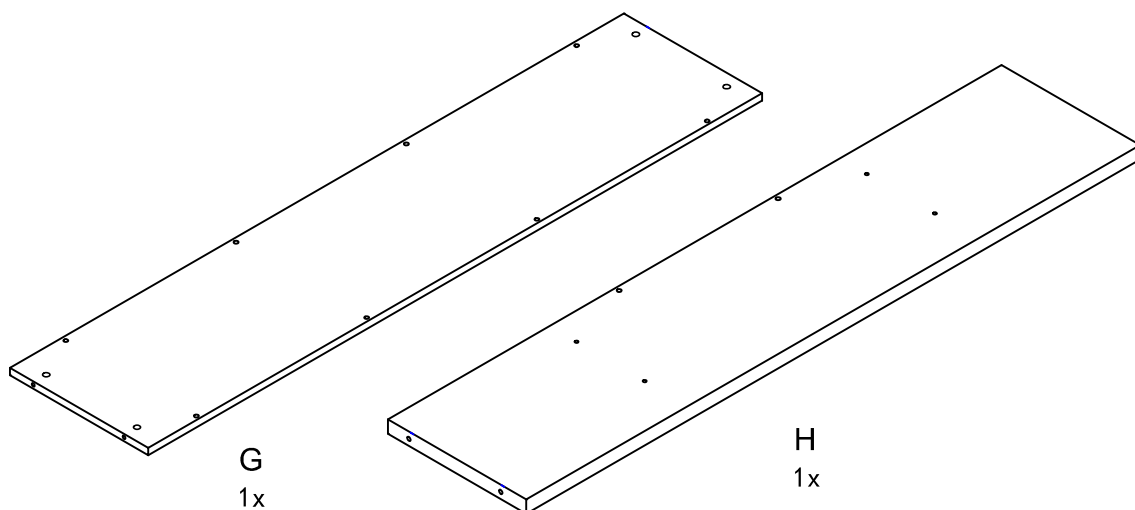

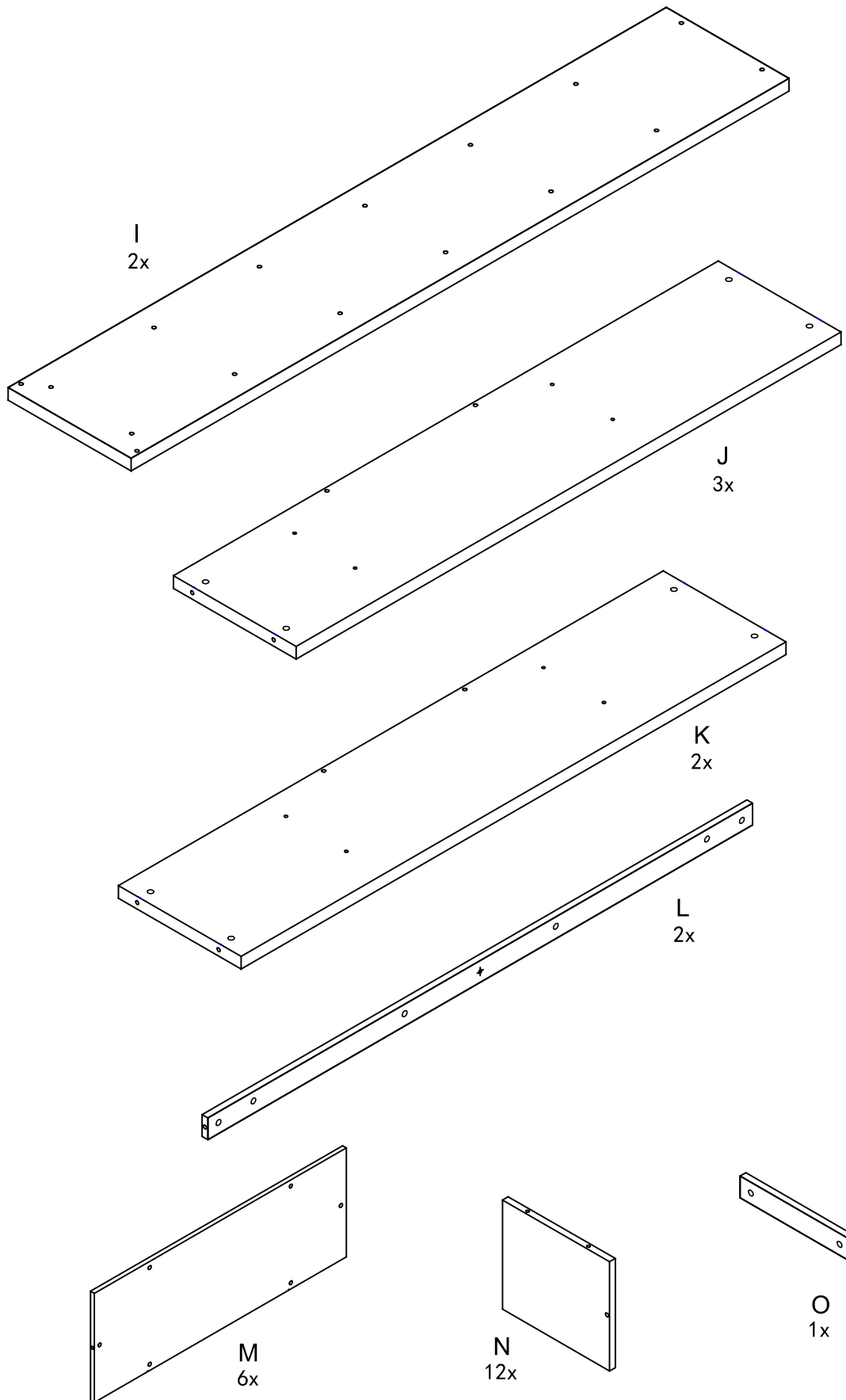

STRUCTUBE

CHICAGO

LACQUER BOOKCASE / ÉTAGÈRE LAQUÉE

Assembly Instructions / Instructions d'assemblage

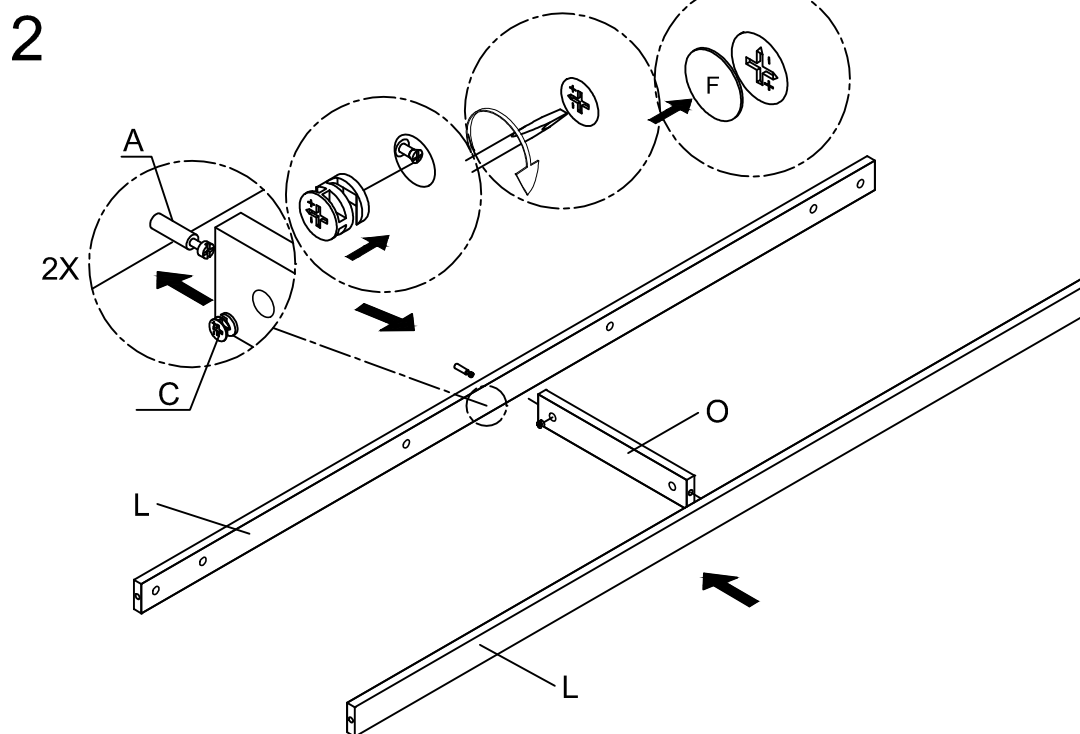
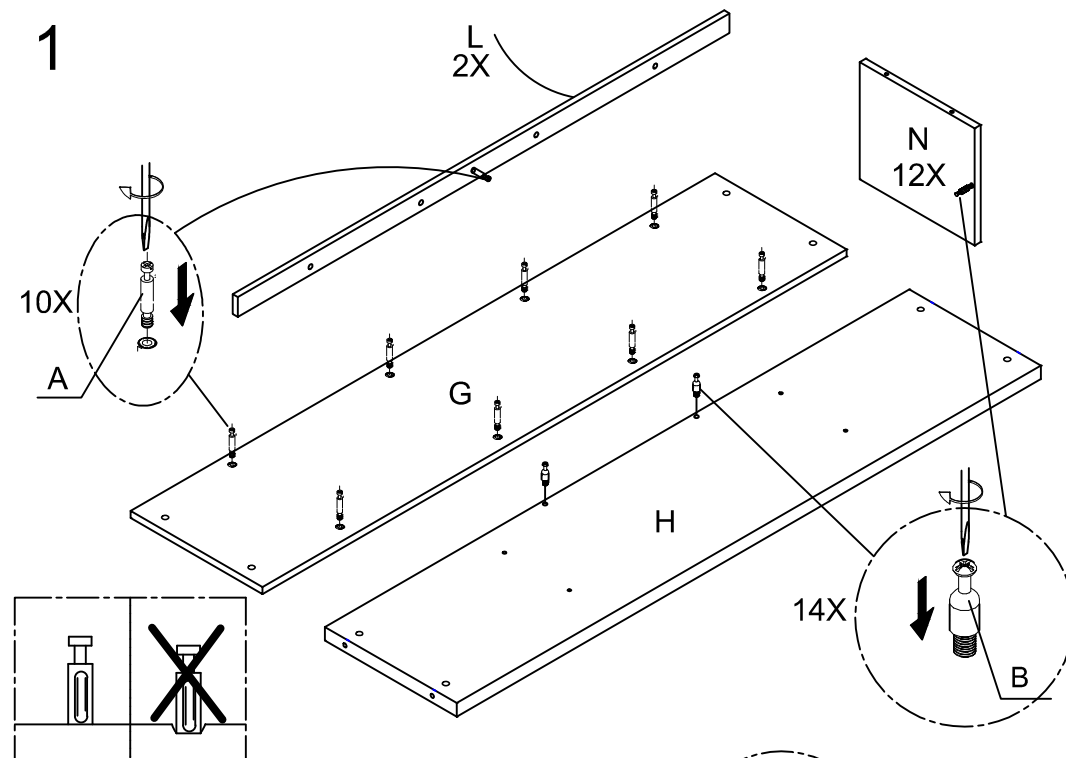

Latest instructions available at/Instructions à jour au : www.structube.com
53.28.16.v_1

For user safety, periodically verify and tighten all fittings.

Pour votre sécurité, veuillez vérifier et resserrer régulièrement tous les raccords.

3

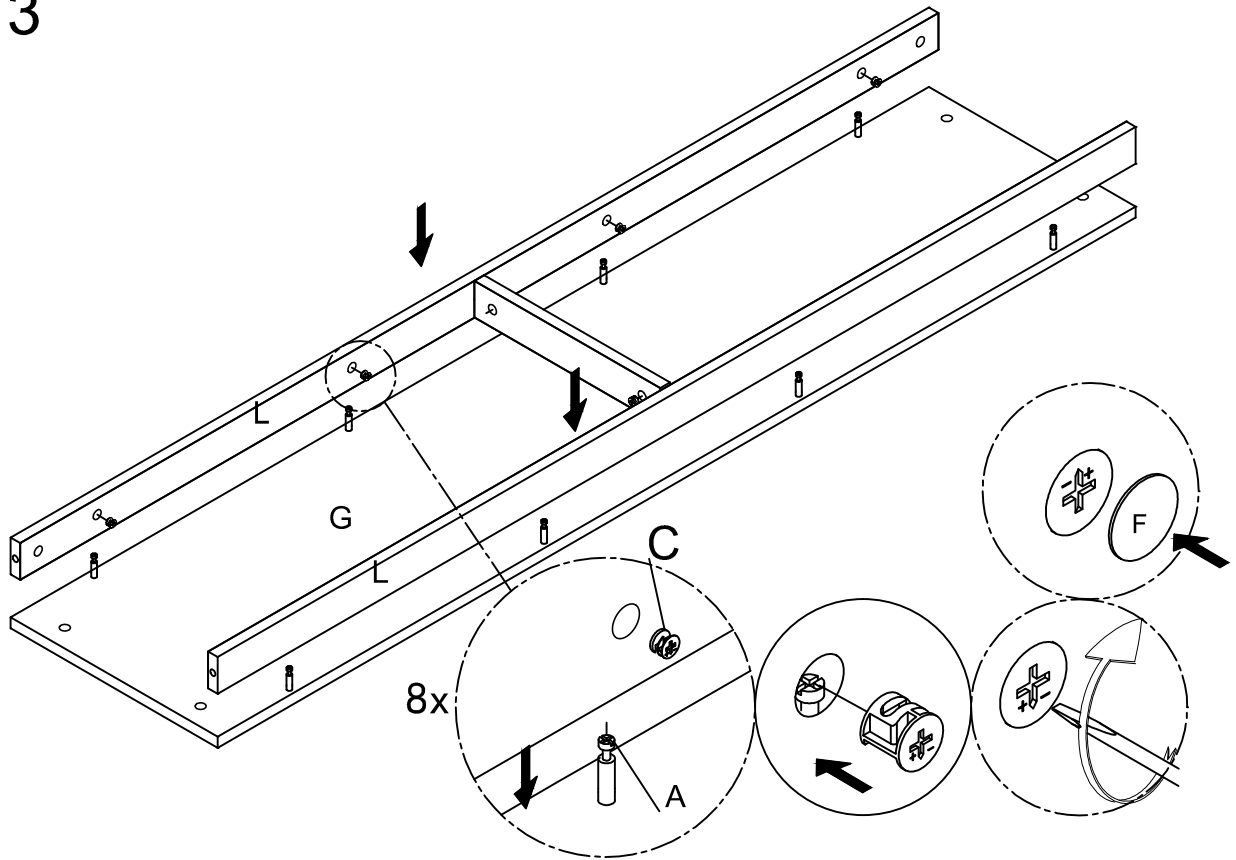

4

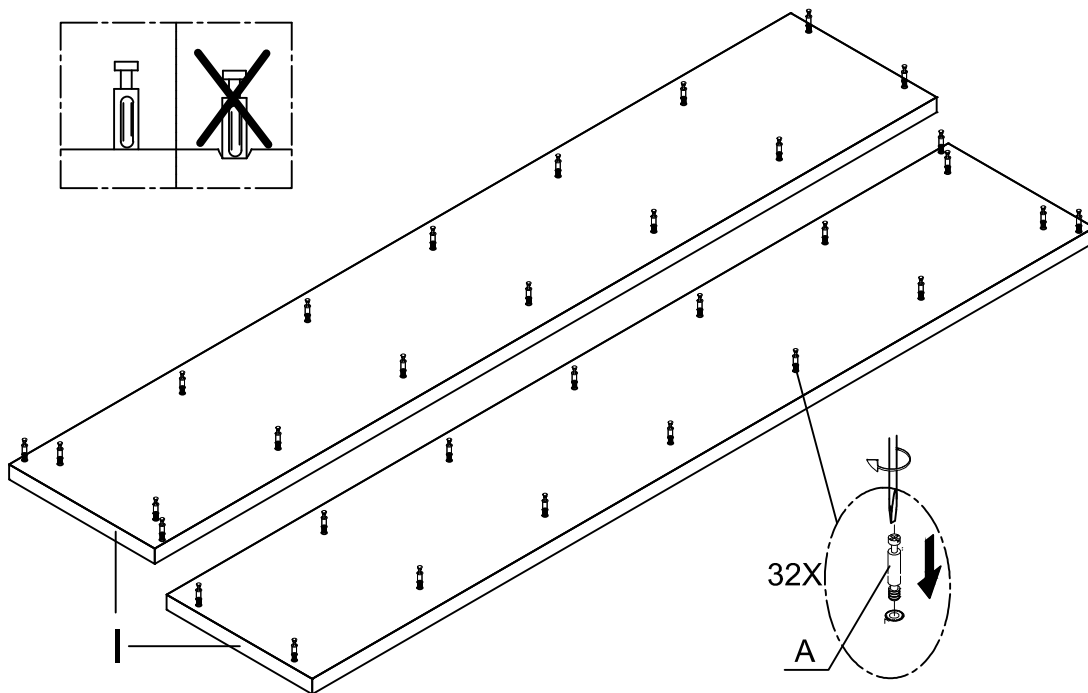

STRUCTUBE

CHICAGO

LACQUER BOOKCASE / ÉTAGÈRE LAQUÉE

Assembly Instructions / Instructions d'assemblage

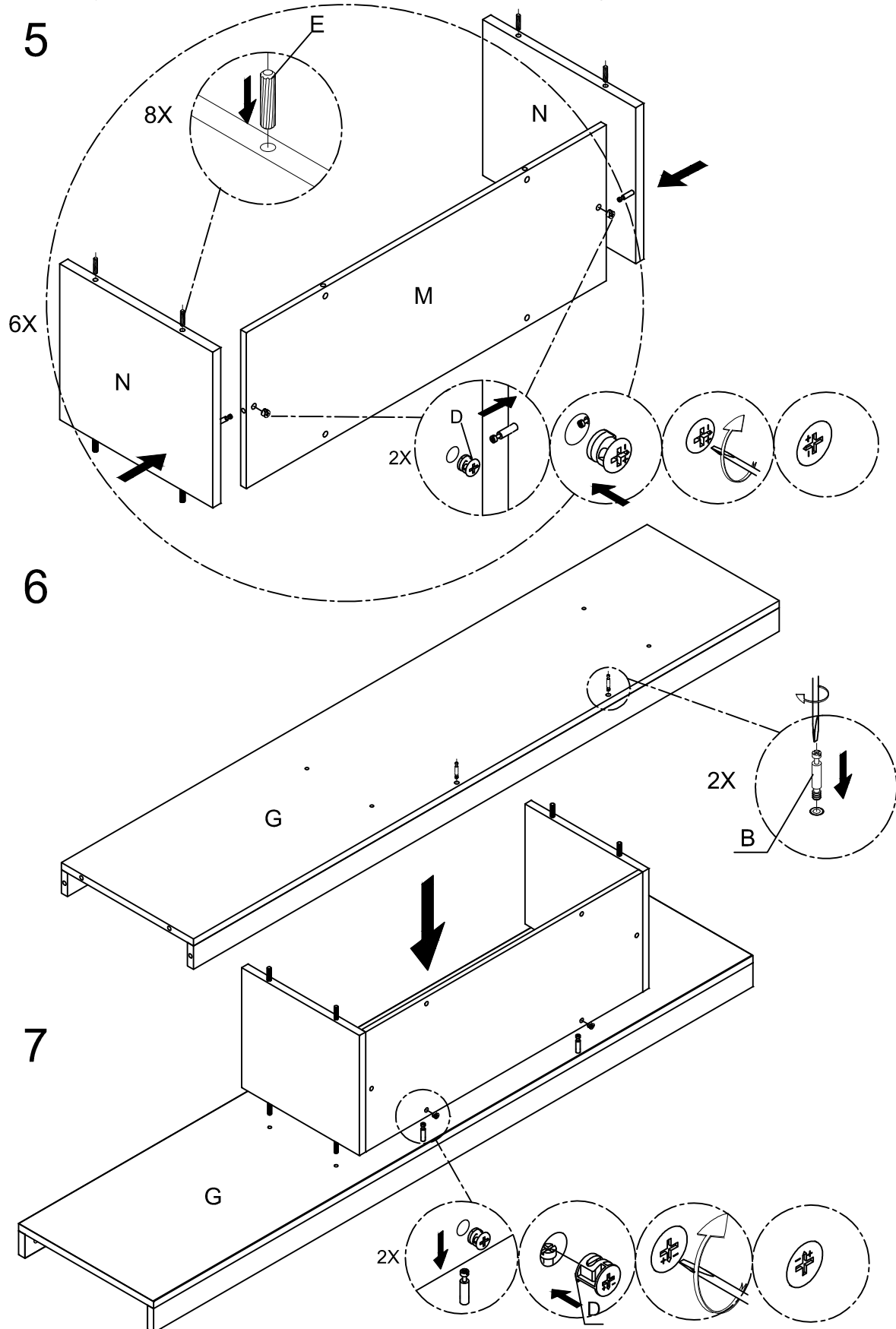

Latest instructions available at/Instructions à jour au : www.structube.com
53.28.16.v_1

For user safety, periodically verify and tighten all fittings.

Pour votre sécurité, veuillez vérifier et resserrer régulièrement tous les raccords.

STRUCTUBE

CHICAGO

LACQUER BOOKCASE / ÉTAGÈRE LAQUÉE

Assembly Instructions / Instructions d'assemblage

8

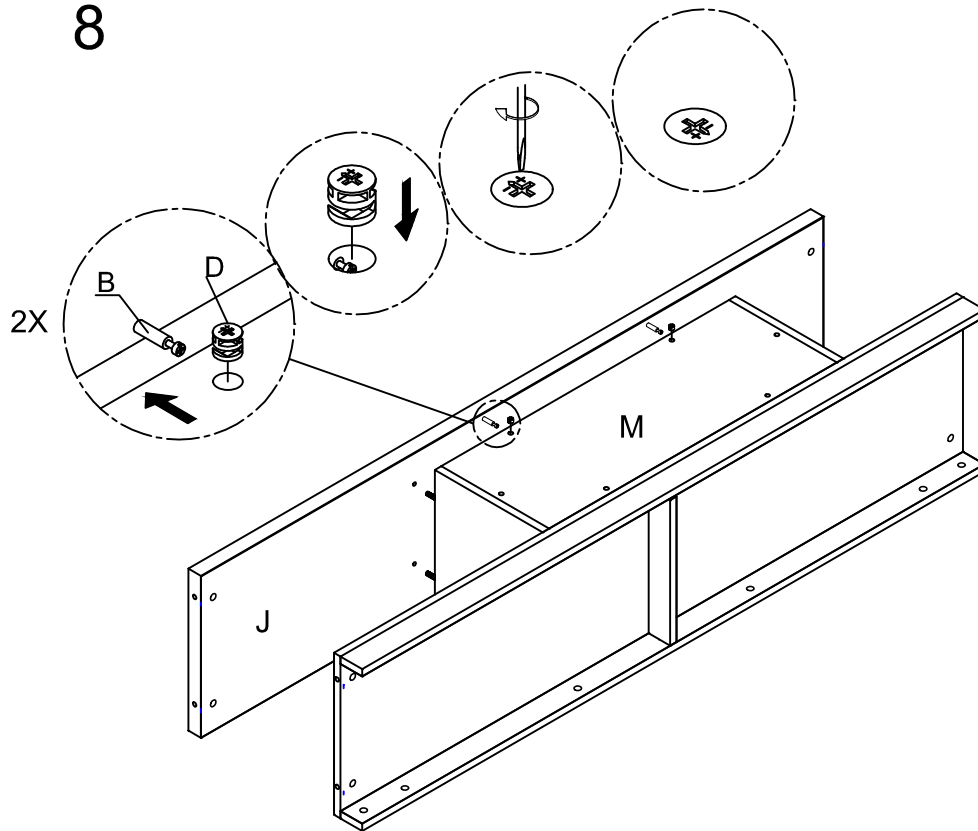

9

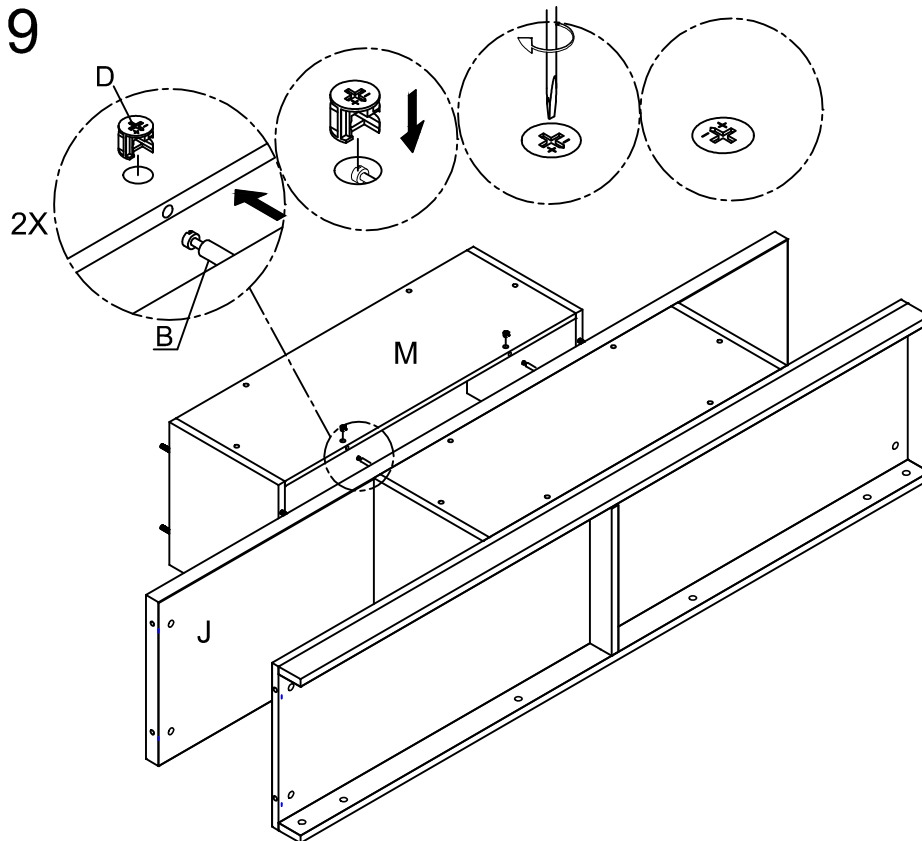

10

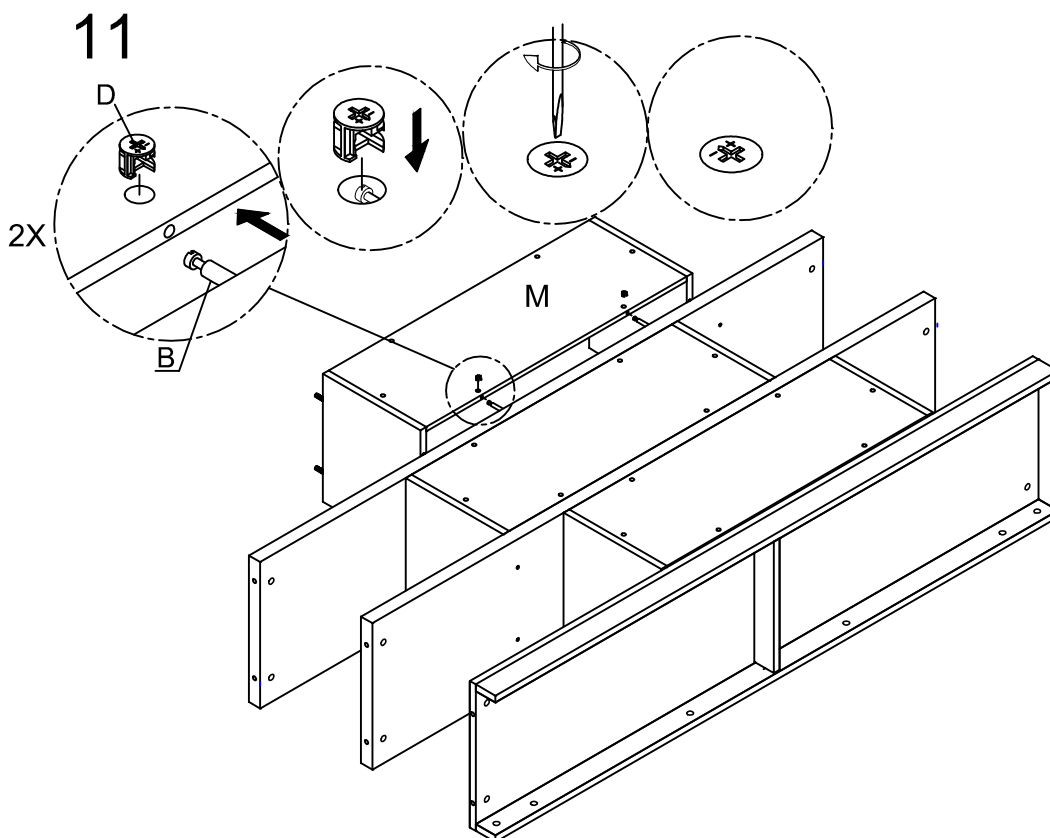
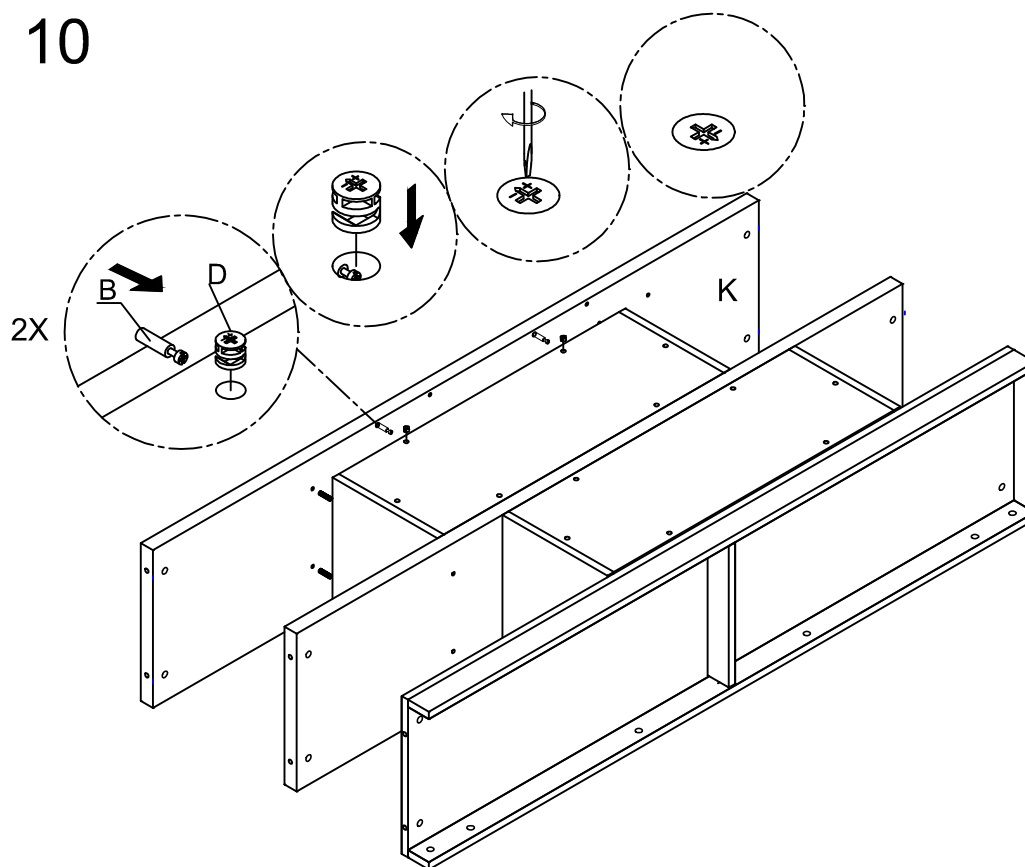

STRUCTUBE

CHICAGO

LACQUER BOOKCASE / ÉTAGÈRE LAQUÉE

Assembly Instructions / Instructions d'assemblage

12

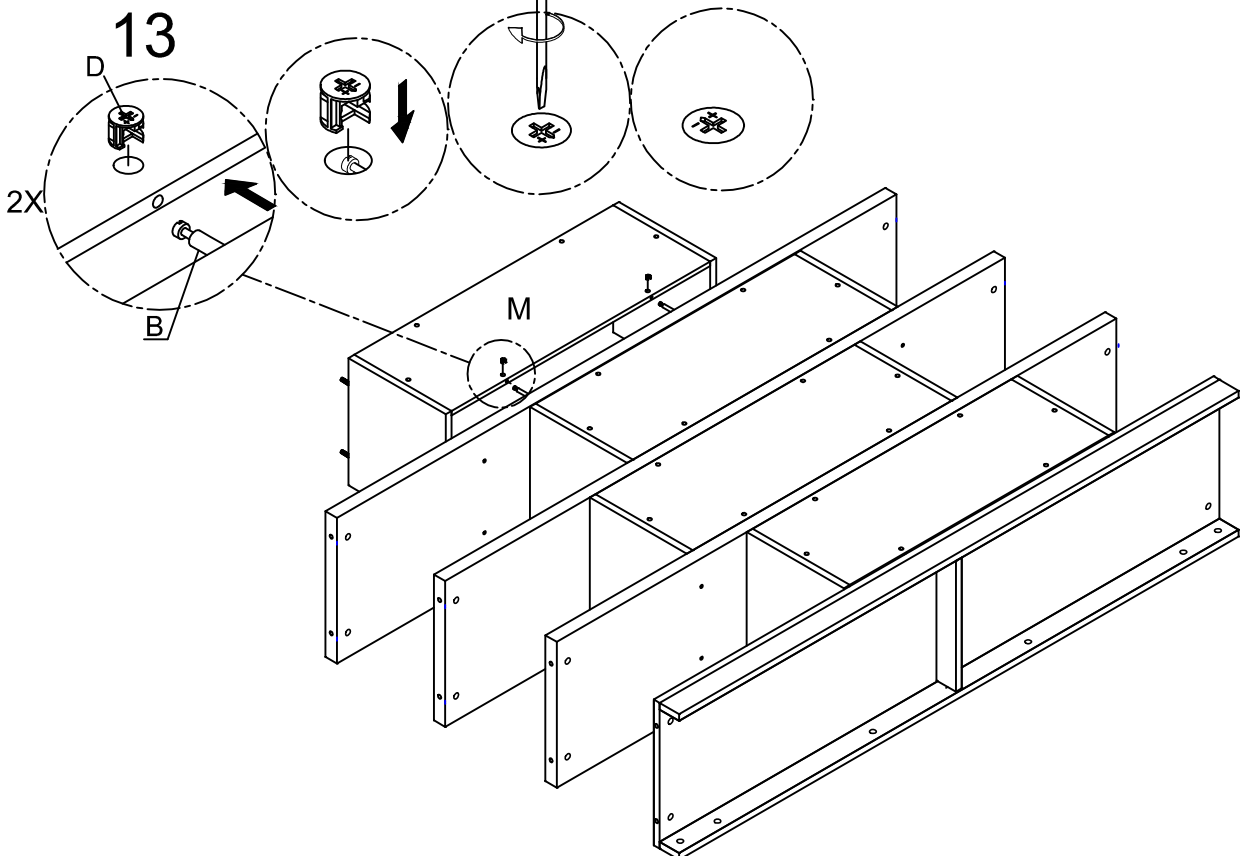
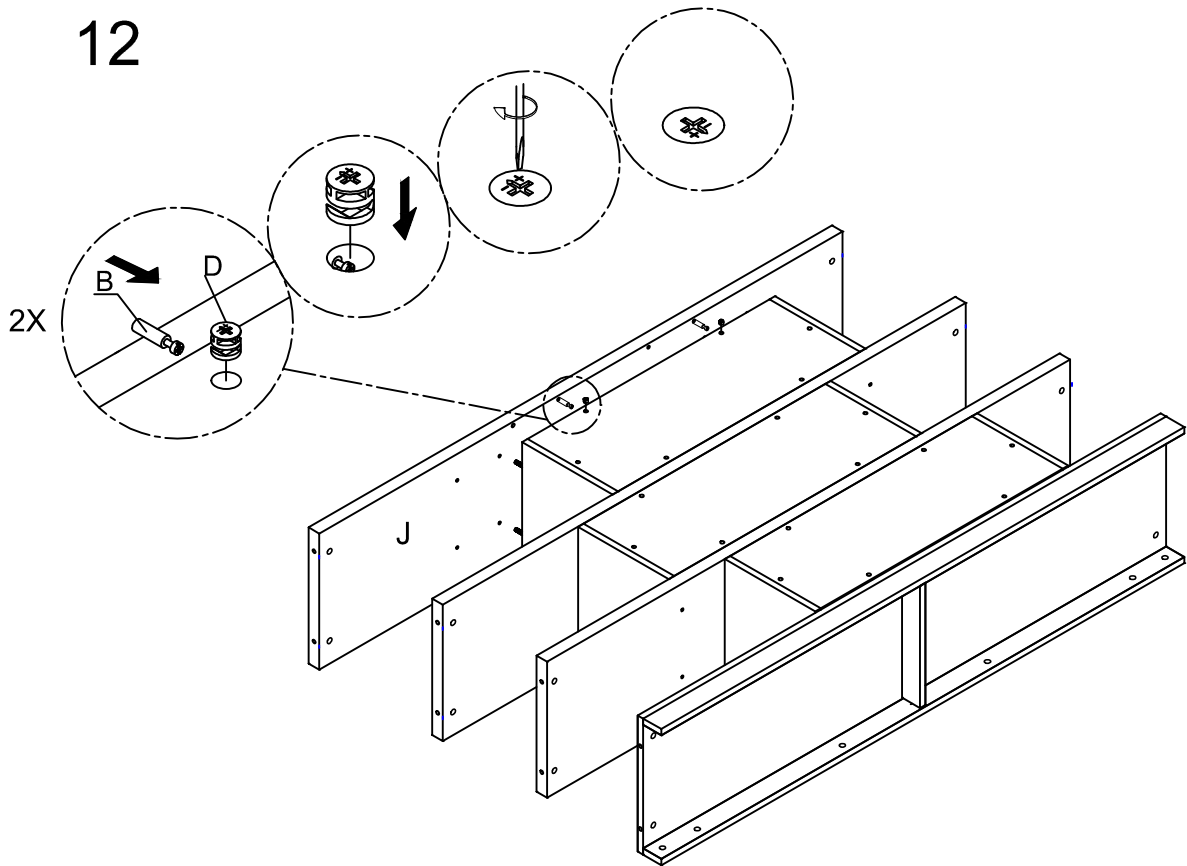

Latest instructions available at/Instructions à jour au : www.structube.com
53.28.16.v_1

For user safety, periodically verify and tighten all fittings.

Pour votre sécurité, veuillez vérifier et resserrer régulièrement tous les raccords.

14

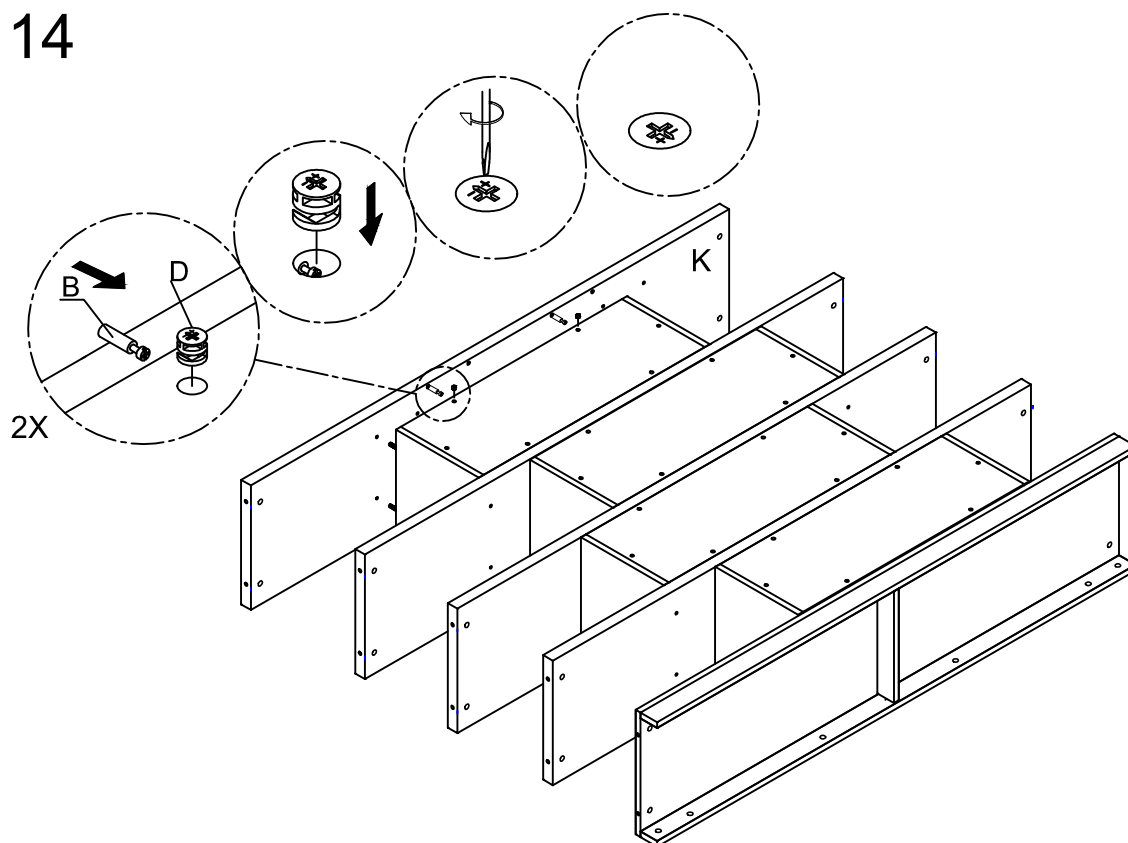

15

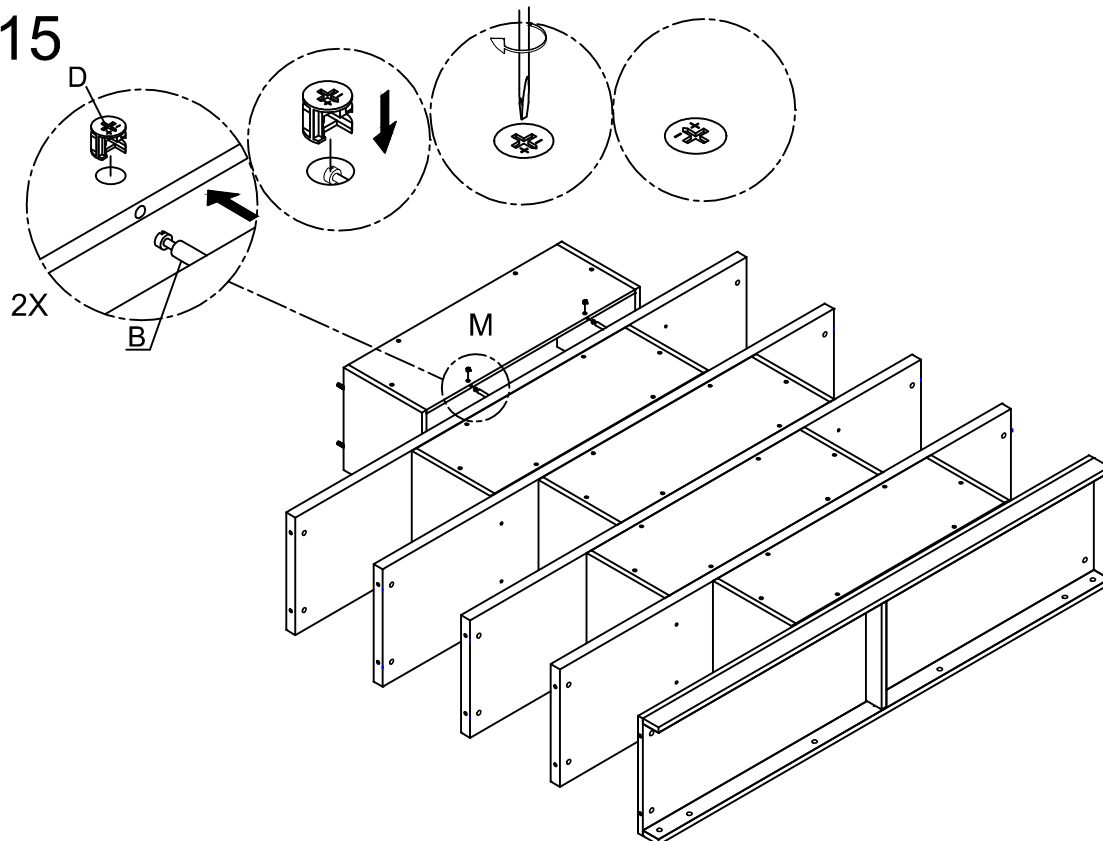

STRUCTUBE

CHICAGO

LACQUER BOOKCASE / ÉTAGÈRE LAQUÉE

Assembly Instructions / Instructions d'assemblage

16

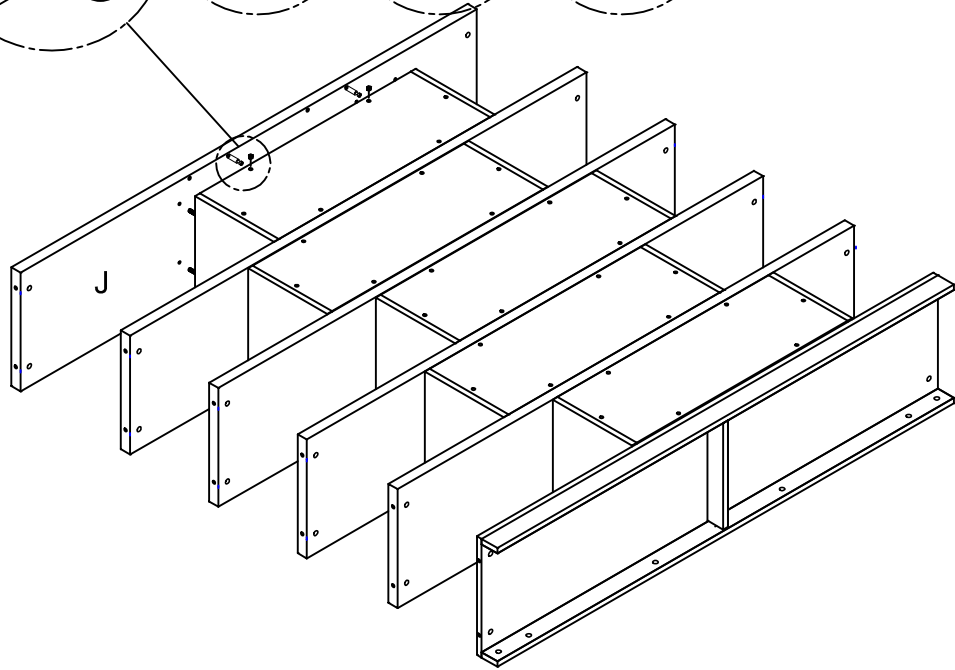
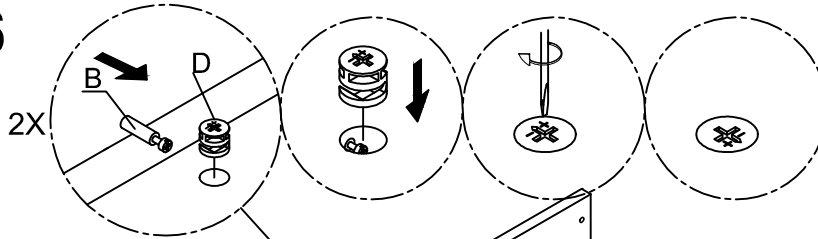

17

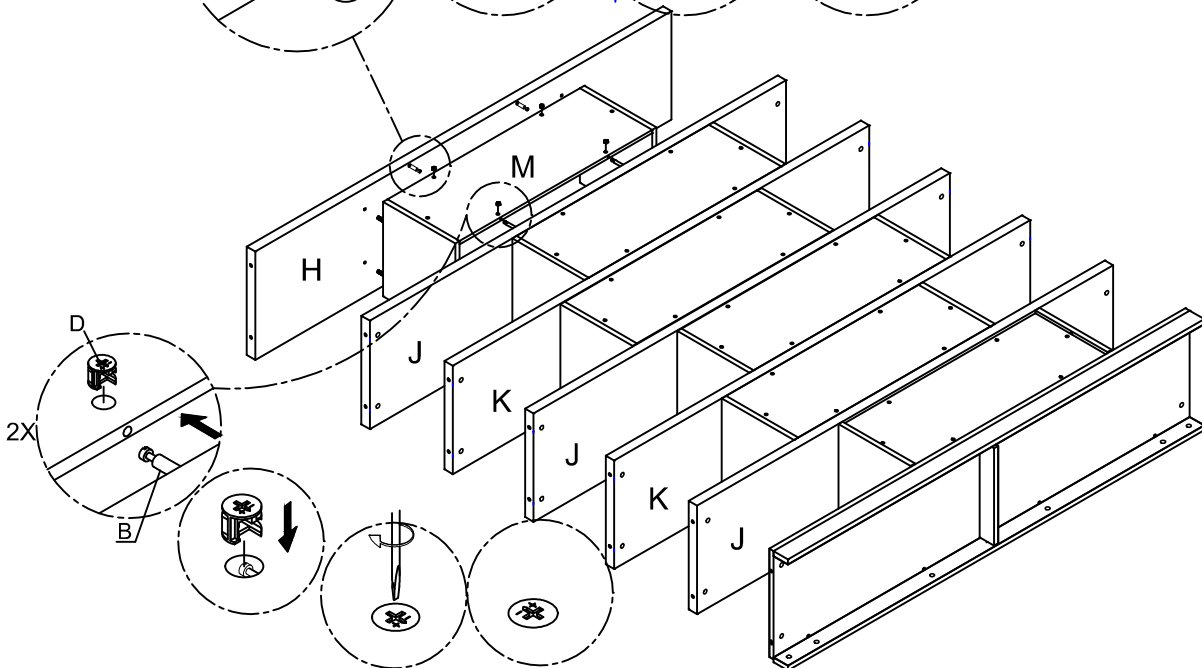
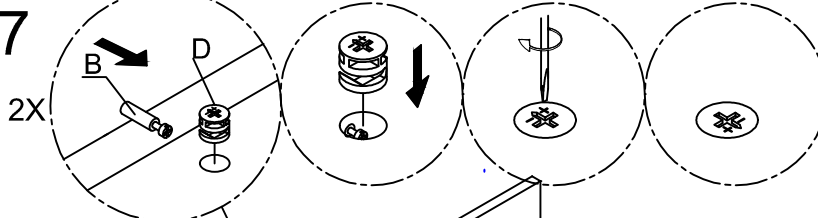

Latest instructions available at/Instructions à jour au : www.structube.com
53.28.16.v_1

For user safety, periodically verify and tighten all fittings.

Pour votre sécurité, veuillez vérifier et resserrer régulièrement tous les raccords.

18

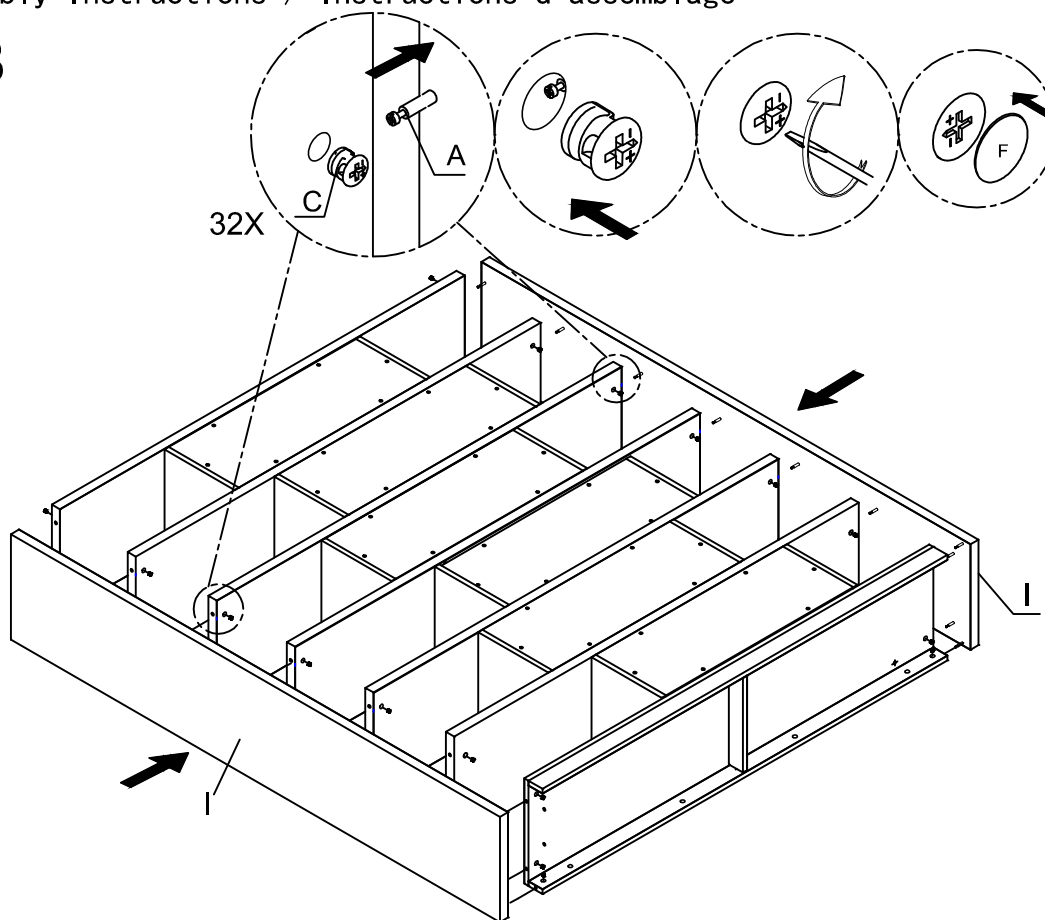

19

